

Architectural CAD, IET-161
Spring 2013, Week 2
In Class Evaluation (ICE)
Evaluation Model, Project Model
20 points total

Name: _____

Day and date: _____

Evaluation Model (10pts)

- Exterior walls - "Exterior - EIFS on Mtl. Stud" - Core Face Exterior – orientation (1pt)
- Permanent and locked dimensions per the drawing below (1pt)
- Reference Planes - centered (1pt) Permanent – Locked - Equality dimension as shown - show values (1pt)
- Interior walls, custom wall from Thursday (1pt), Interior hall - 4' - centered on one of the planes – Permanent - locked dimension (1pt)
- Interior walls, 3 rooms of your choice (1pt)
- Front door, Load Family - Double-Panel 2.rfa - on one of the end walls 72" x 84" (1pt), centered - Equality dimensions - show values (1pt)
- Windows, doors, 6 additional of your choice - orientation (1pt)
- Errors and Extras

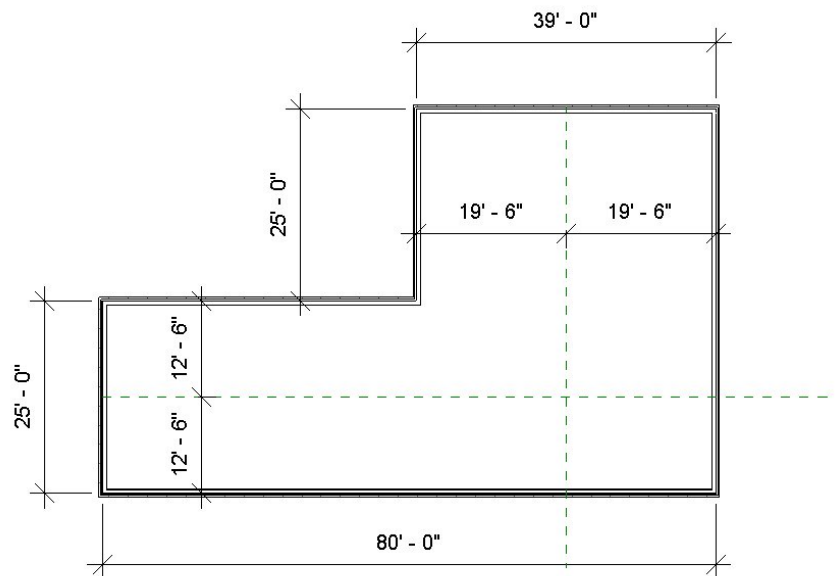

Project Model (10 points total)

- Exterior walls, your choice - Core Face Exterior- Permanent and locked dimensions – orientation (1pt)
- Reference Plane, centered (1pt) Permanent – locked - Equality dimension as shown - show values (1pt)
- Interior walls, Interior hall – width of your choosing, centered on one of the planes – Permanent - locked dimension (1pt)
- Interior walls, at least 6 rooms of your choice (1pt) dimension one of the rooms – Permanent (1pt)
- Interior or exterior walls, one angled and one radius wall (1pt)
- Doors of your choosing, Load Family for front door (1pt)
- Windows, Load Family of your choosing - level 1 - all sides – orientation (1pt)
- Dimensions, at least 8 on doors and windows – Permanent (1pt)
- Errors and Extras