

4

3

2

1

**SHEET NOTES**

1. ORIGIN AT THE CENTER OF THE BASE FEATURE, EXTRUDE IN THE TOP DIRECTION.
2. HOLE TYPE - COUNTER BORE, ANSI INCH, 1/4 INCH BINDING HEAD SCREW HOLE, CLOSE FIT WITH A 0.0500 INCH HEAD CLEARANCE.
3. BASE FEATURE WITH FILLET - MASS: 1.3543 POUNDS, CENTER OF MASS: X = 0.0000, Y = 0.3723, Z = 0.0000
4. WITH WHEEL MOUNT CUT AND HOLES - MASS: 1.3363 POUNDS, CENTER OF MASS: X = -0.0675, Y = 0.3696, Z = 0.0115
5. WITH HINGE CUTS 1 AND 2 - MASS: 1.2331 POUNDS, CENTER OF MASS: X = 0.2898, Y = 0.3490, Z = 0.0263
6. FINAL - MASS: 1.2245 POUNDS, CENTER OF MASS: X = 0.3147, Y = 0.3469, Z = 0.0351

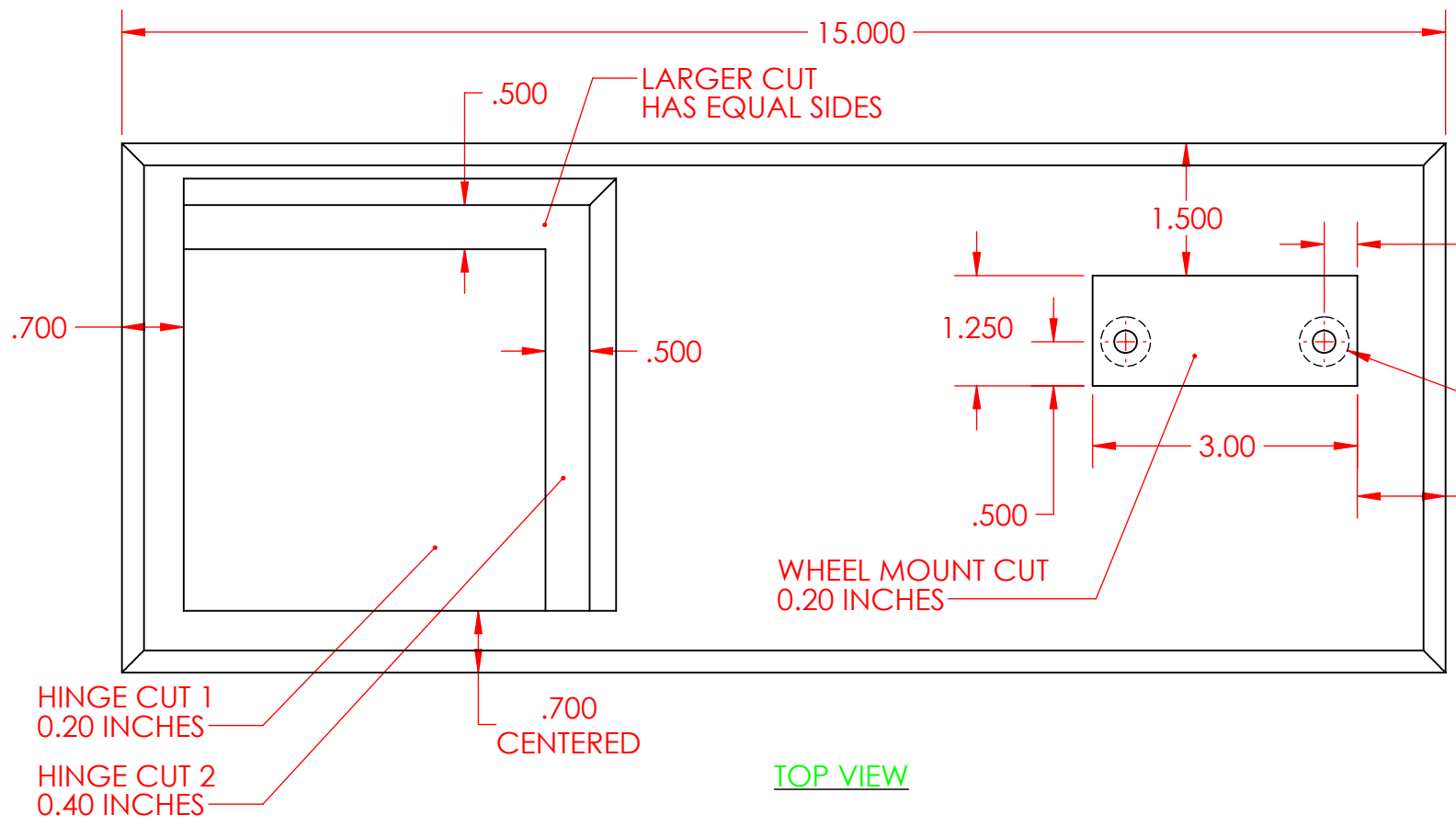

**TOP VIEW**



**FRONT TOP RIGHT ISOMETRIC VIEW**

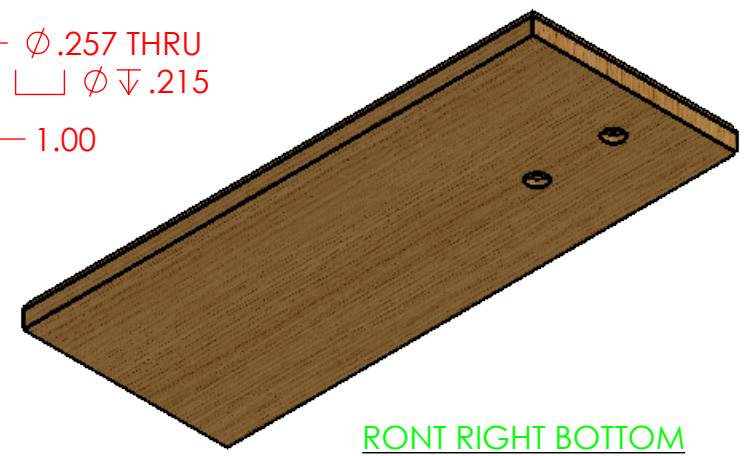

**FRONT RIGHT BOTTOM ISOMETRIC VIEW**

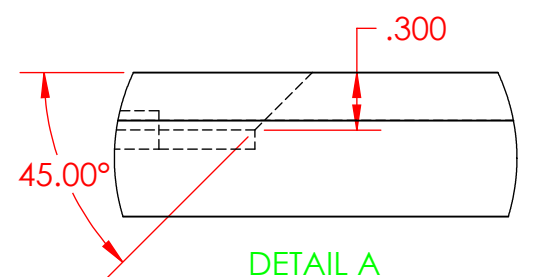

**DETAIL A SCALE 1:1 CHAMFER DETAIL**

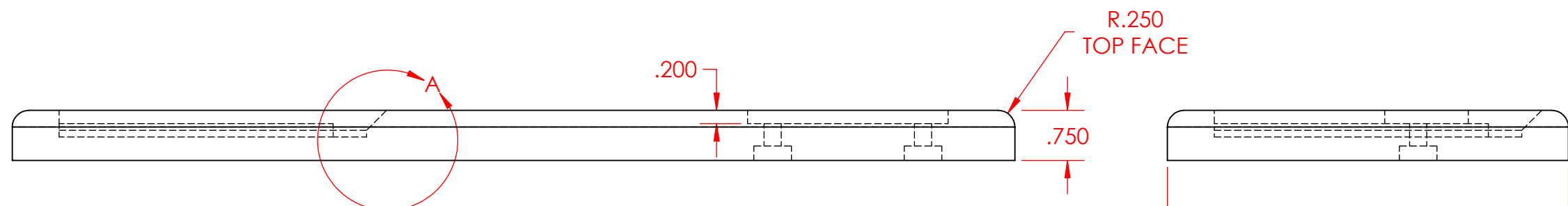

**FRONT VIEW**

**RIGHT VIEW**

**PROPRIETARY AND CONFIDENTIAL**

THE INFORMATION CONTAINED IN THIS DRAWING AND ANY RELATED MATERIAL IS THE SOLE PROPERTY OF ENTERPRISE DESIGN AND INNOVATIONS. ANY SHARING OF THIS INFORMATION, IN WHOLE OR ANY PART THEREOF IS PROHIBITED WITHOUT EXPRESS WRITTEN CONSENT OF ENTERPRISE DESIGN AND INNOVATIONS.

<b>SARRUS MECHANISM BASE PLATE</b>				REVISIONS DATE:	ITEM:	NAME	DATE	UNITS IN INCHES TOLERANCES ARE 0.010 INCHES UNLESS OTHERWISE NOTED	
<b>SARRUS MECHANISM</b>						DRAWN	CSS		10/4/17
<b>VARIOUS VIEWS</b>						CHECKED	000		000
						APPV.	000		000
						MATERIAL	Oak		
SHEET	SHEET SCALE	SHEET SIZE	REV			VERSION DATE	10/9/2017		
<b>1</b>	<b>1:4</b>	<b>B</b>				SHEET FILE NAME: 171004-2016-Sarrus-Base-Plate			



4

3

2

1

B

B

A

A