

4

3

2

1

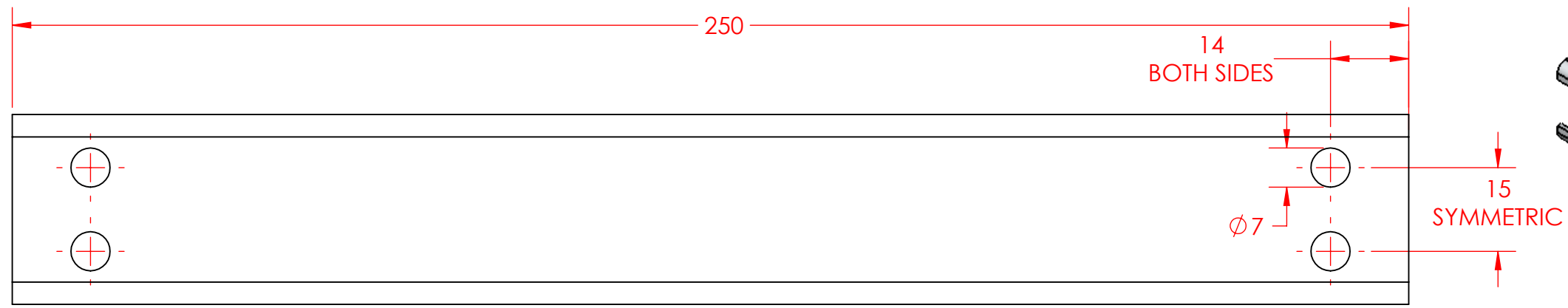

TOP VIEW

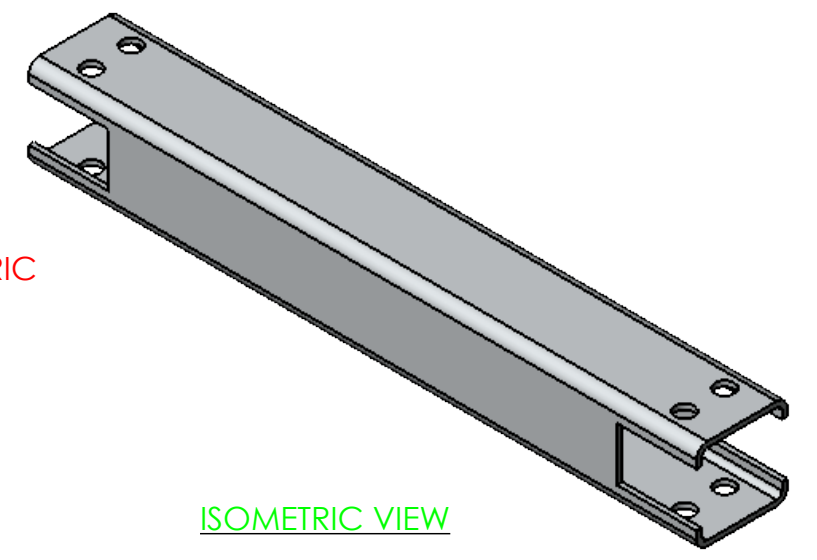

ISOMETRIC VIEW

SHEET NOTES:

SUGGESTED MODELING ORDER:

1. TUBING EXTRUSION - MASS: 165.847 GRAMS, X=0.000, Y=0.000, Z=0.000
2. END CUTS - MASS: 152.887 GRAMS, X=0.000, Y=0.000, Z=0.000
3. HOLE WIZARD - HOLE WIZARD HOLE ANSI METRIC, DRILL HOLE, 7.0 MM, THROUGH ALL
 1. MASS: 151.224, X=0.000, Y=0.000, Z=0.000

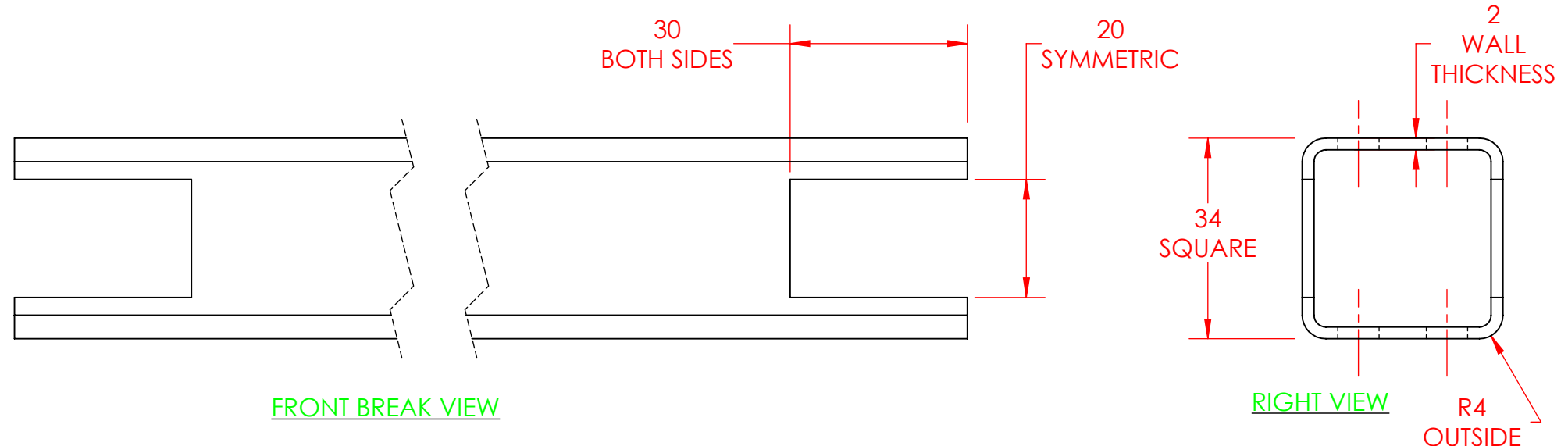

FRONT BREAK VIEW

RIGHT VIEW

PROPRIETARY AND CONFIDENTIAL

THE INFORMATION CONTAINED IN THIS DRAWING AND ANY RELATED MATERIAL IS THE SOLE PROPERTY OF ENTERPRISE DESIGN AND INNOVATIONS. ANY SHARING OF THIS INFORMATION, IN WHOLE OR ANY PART THEREOF IS PROHIBITED WITHOUT EXPRESS WRITTEN CONSENT OF ENTERPRISE DESIGN AND INNOVATIONS.

CUT TUBING 098768				REVISIONS DATE:	ITEM:	NAME	DATE	UNITS IN MILLIMETERS TOLERANCES ARE 0.25 INCHES UNLESS OTHERWISE NOTED	
STRUCTURAL ALUMINUM						DRAWN	CSS		1/11/18
GENERAL						CHECKED	000		000
						APPV.	000		000
						MATERIAL	6061-T6 (SS)		
SHEET 1	SHEET SCALE 1:1	SHEET SIZE B	REV			VERSION DATE	1/11/2018		
				SHEET FILE NAME: 02-Square-Tubing-Cuts					



4

3

2

1

A

A