

4

3

2

1

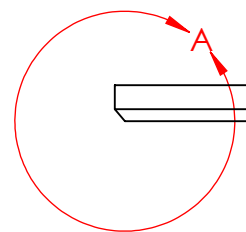
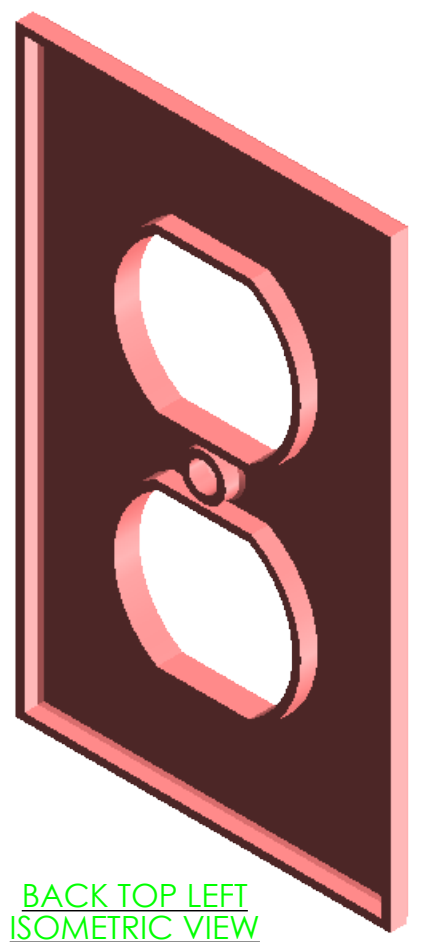

TOP VIEW

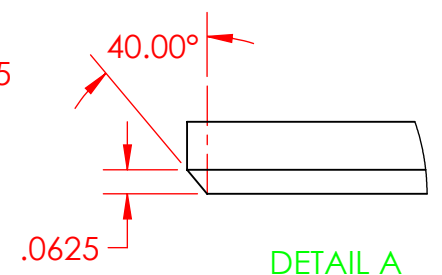

DETAIL A
SCALE 2:1
CHAMFER DETAIL

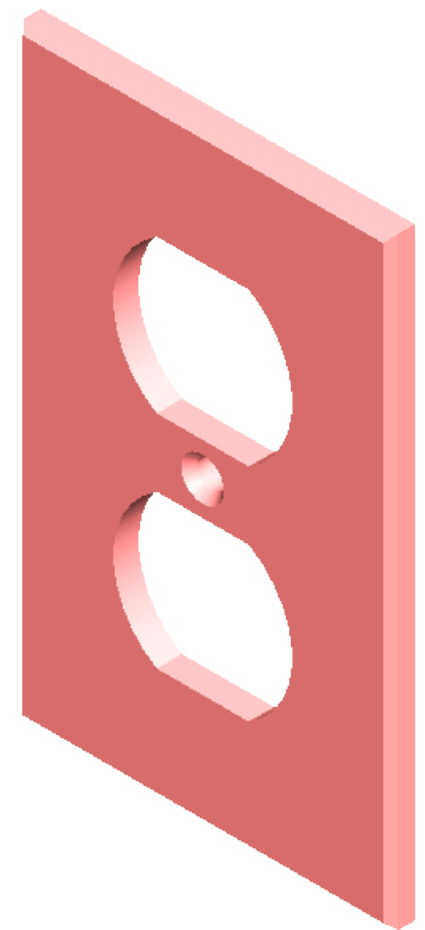

FRONT-TOP-RIGHT ISOMETRIC VIEW

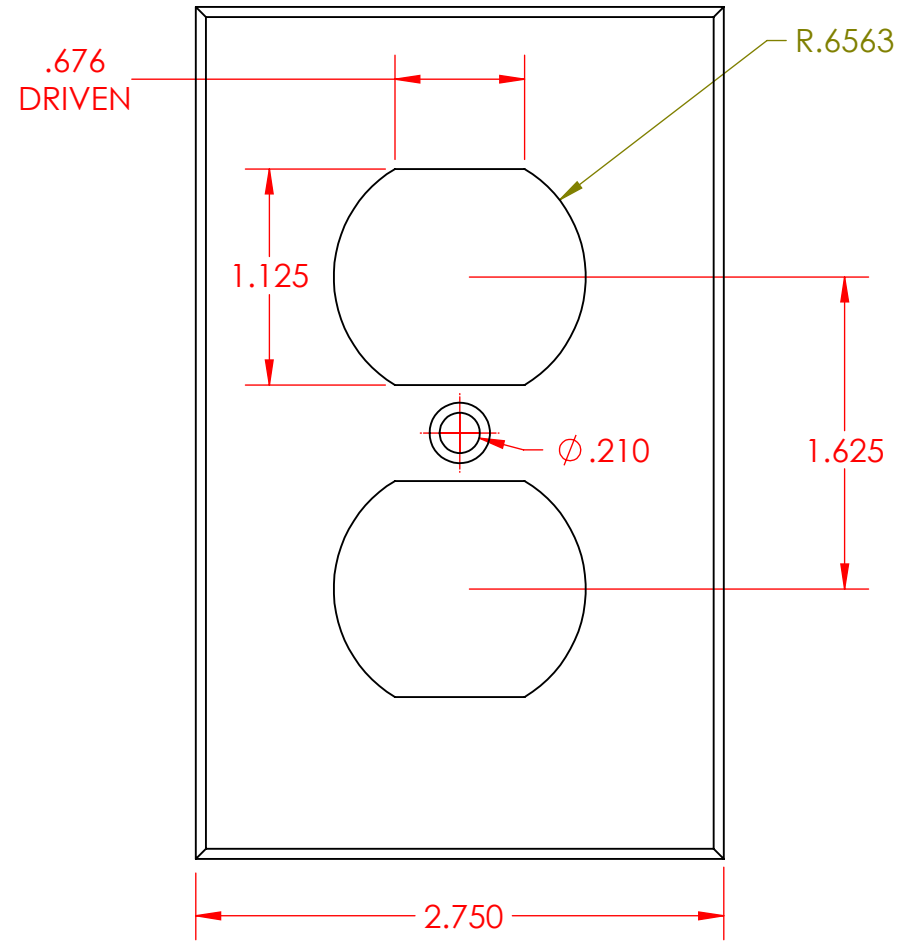

FRONT VIEW



RIGHT VIEW

- SHEET NOTES: SUGGEST FEATURE ORDER AND PROPERTIES**
1. BASE FEATURE EXTRUDE TO THE FRONT
 1. MASS = 0.1075 POUNDS
 2. CENTER OF MASS: X = 0.0000, Y = 0.0000, Z = 0.0938
 2. RECEPTACLE CUT
 1. MASS = 0.0851 POUNDS
 2. CENTER OF MASS: X = 0.0000, Y = 0.0000, Z = 0.0938
 3. MOUNTING HOLE
 1. MASS = 0.0848 POUNDS
 2. CENTER OF MASS: X = 0.0000, Y = 0.0000, Z = 0.0938
 4. EDGE CHAMFER
 1. MASS = 0.0837 POUNDS
 2. CENTER OF MASS: X = 0.0000, Y = 0.0000, Z = 0.0927
 5. BACK SHELL 0.0625 INCHES
 1. MASS = 0.0359 POUNDS
 2. CENTER OF MASS: X = 0.0000, Y = 0.0000, Z = 0.1332

PROPRIETARY AND CONFIDENTIAL

THE INFORMATION CONTAINED IN THIS DRAWING AND ANY RELATED MATERIAL IS THE SOLE PROPERTY OF ENTERPRISE DESIGN AND INNOVATIONS. ANY SHARING OF THIS INFORMATION, IN WHOLE OR ANY PART THEREOF IS PROHIBITED WITHOUT EXPRESS WRITTEN CONSENT OF ENTERPRISE DESIGN AND INNOVATIONS.

OUTLET PLATE DESIGN ELECTRICAL MODELS VARIOUS VIEWS				REVISIONS DATE:	ITEM:	NAME	DATE	UNITS IN INCHES TOLERANCES ARE 0.010 INCHES UNLESS OTHERWISE NOTED
						DRAWN	CSS	
		CHECKED	000	000				
		APPV.	000	000				
		MATERIAL	PVC Rigid					
SHEET 1	SHEET SCALE 1:1	SHEET SIZE B	REV	VERSION DATE	3/30/2018			
				SHEET FILE NAME: 01-Outlet-Plate				



4

3

2

1

B

B

A

A