

4

3

2

1

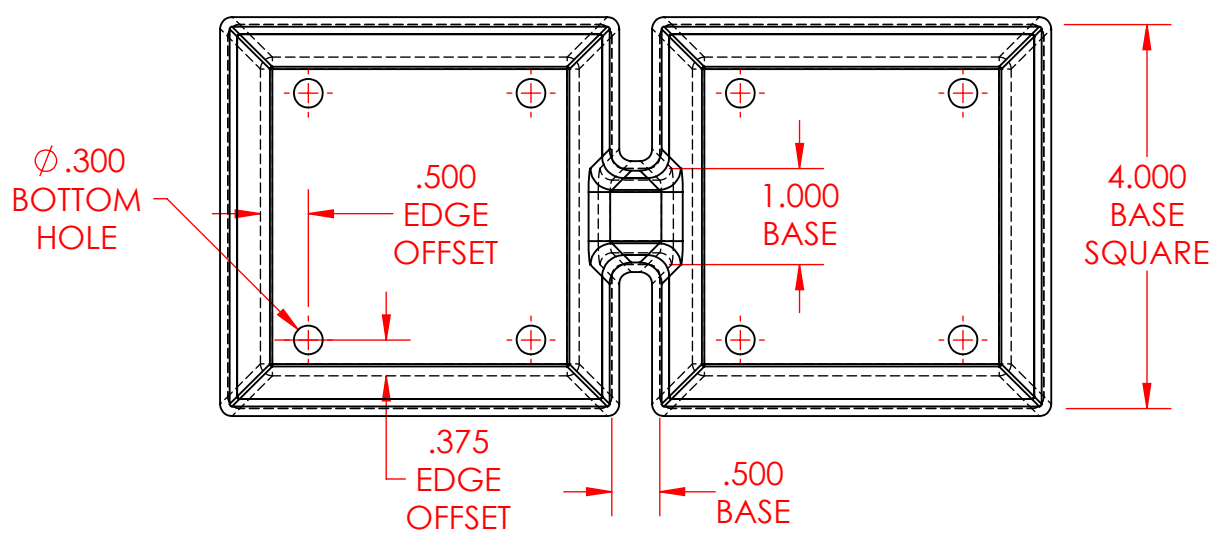

- SHEET NOTES**
DESIGN STEP INFORMATION AND SUGGESTED FEATURE ORDER
1. BASE FEATURE - TOP PLANE - EXTRUDE DOWN - MASS = 3.747 POUNDS - CENTER OF MASS: X = 0, Y = -1.873, Z = 0
 2. TOP LIP - MASS = 5.487 POUNDS - CENTER OF MASS: X = 0, Y = -1.039, Z = 0
 3. CONNECTOR CUT - MASS = 5.445 POUNDS - CENTER OF MASS: X = 0, Y = -1.026, Z = 0
 4. EDGE FILLET - MASS = 5.439 POUNDS - CENTER OF MASS: X = 0, Y = -1.024, Z = 0
 5. TOP SHELL - MASS = 0.609 POUNDS - CENTER OF MASS: X = 0, Y = -1.458, Z = 0
 6. BOTTOM HOLES - MASS = 0.607 POUNDS - CENTER OF MASS: X = 0, Y = -1.450, Z = 0

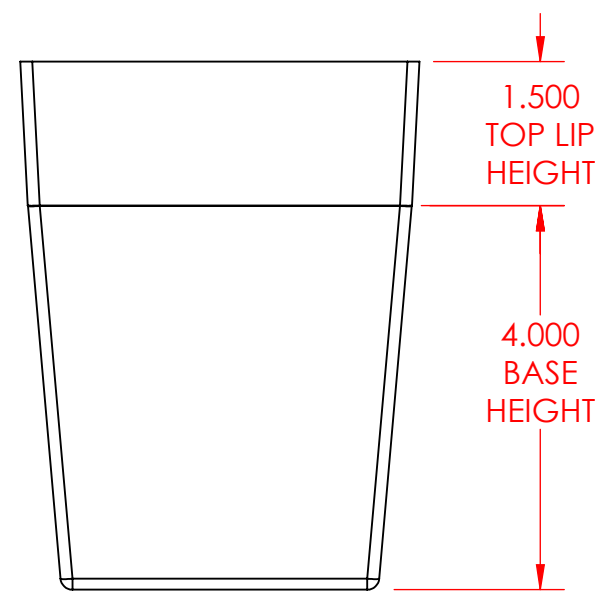
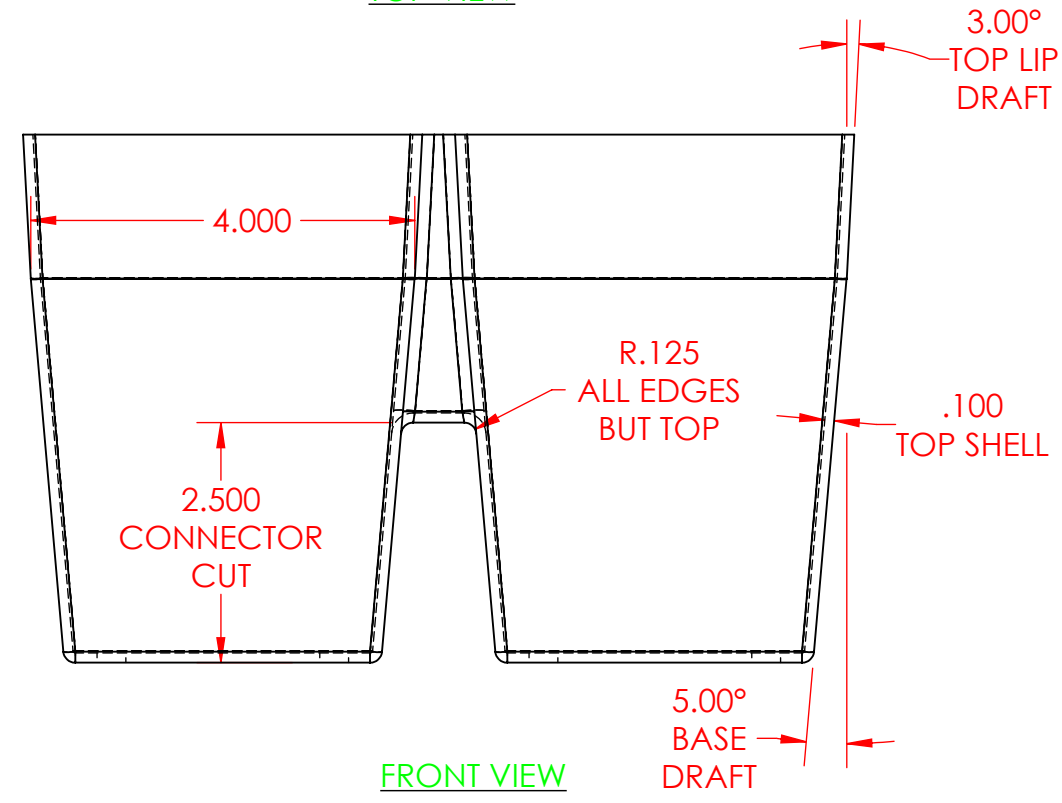
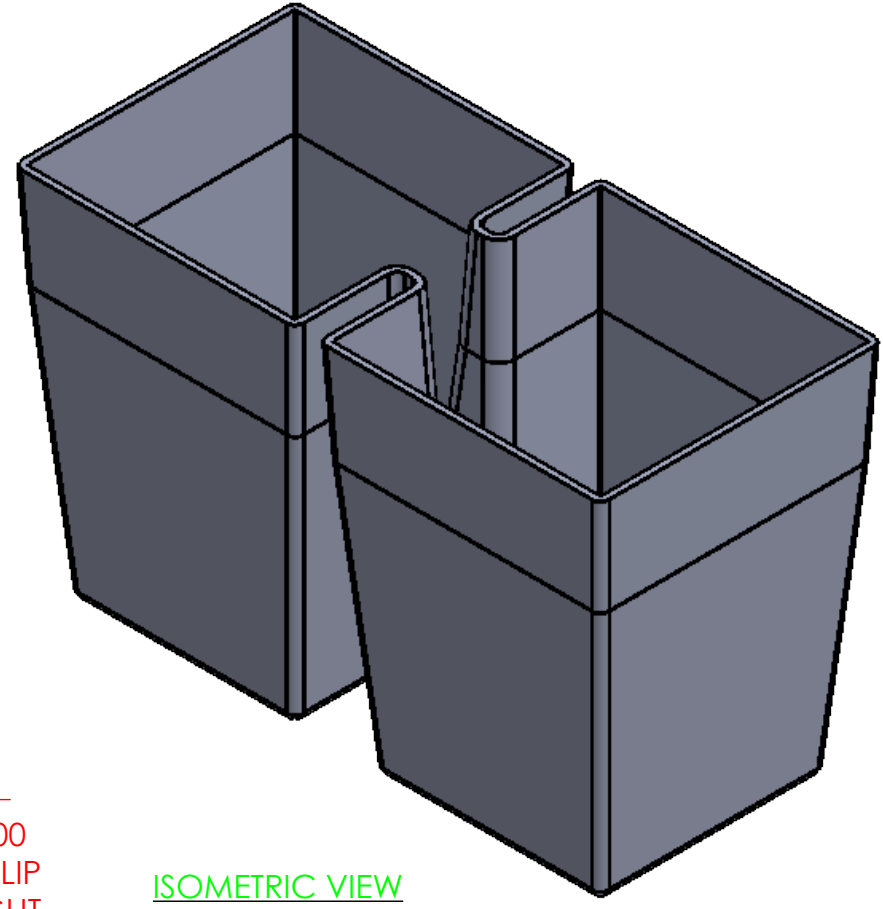

PROPRIETARY AND CONFIDENTIAL

THE INFORMATION CONTAINED IN THIS DRAWING AND ANY RELATED MATERIAL IS THE SOLE PROPERTY OF ENTERPRISE DESIGN AND INNOVATIONS. ANY SHARING OF THIS INFORMATION, IN WHOLE OR ANY PART THEREOF IS PROHIBITED WITHOUT EXPRESS WRITTEN CONSENT OF ENTERPRISE DESIGN AND INNOVATIONS.

PE PLANTING POT - 456				REVISIONS DATE:	ITEM:	NAME	DATE	UNITS IN INCHES TOLERANCES ARE 0.010 INCHES UNLESS OTHERWISE NOTED	
PLANTING POTS						DRAWN	CSS		4/2/18
GARDENING ITEMS						CHECKED	000		000
						APPV.	000		000
						MATERIAL	PE High Density		
SHEET 1	SHEET SCALE 1:2	SHEET SIZE B	REV			VERSION DATE	4/1/2018		
				SHEET FILE NAME: 02-Planting-Pot					



4

3

2

1