

SHEET NOTES

SUGGESTED FEATURE ORDER FOR DESIGN

1. BASE EXTRUDE - MIDPLANE TO LENGTH SHOWN - MASS = 0.2169 POUNDS, CENTER OF MASS:
X = 0, Y = 0.2030, Z = 0.2030
2. EDGE FILLET - MASS = 0.2160 POUNDS, CENTER OF MASS:
X = 0, Y = 0.2025, Z = 0.2025
3. BOTTOM HOLE - PATTERN AND MIRROR - MASS = 0.2093 POUNDS, CENTER OF MASS:
X = 0, Y = 0.2079, Z = 0.1946
4. BACK HOLES - SLOT COINCIDENT WITH THE CENTER OF THE EDGE HOLES - MASS = 0.2016 POUNDS,
CENTER OF MASS: X = 0, Y = 0.1986, Z = 0.2010

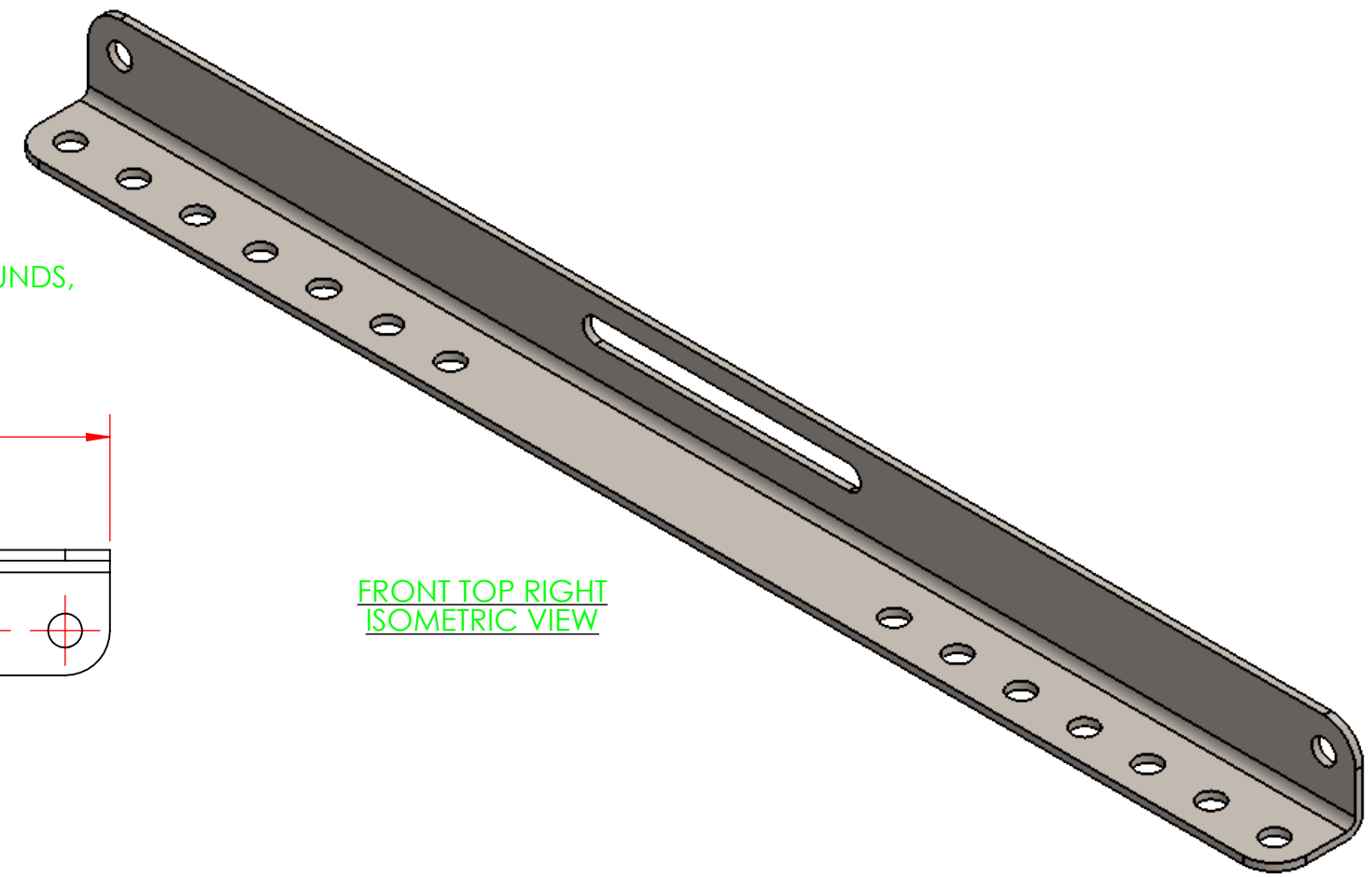

FRONT TOP RIGHT ISOMETRIC VIEW

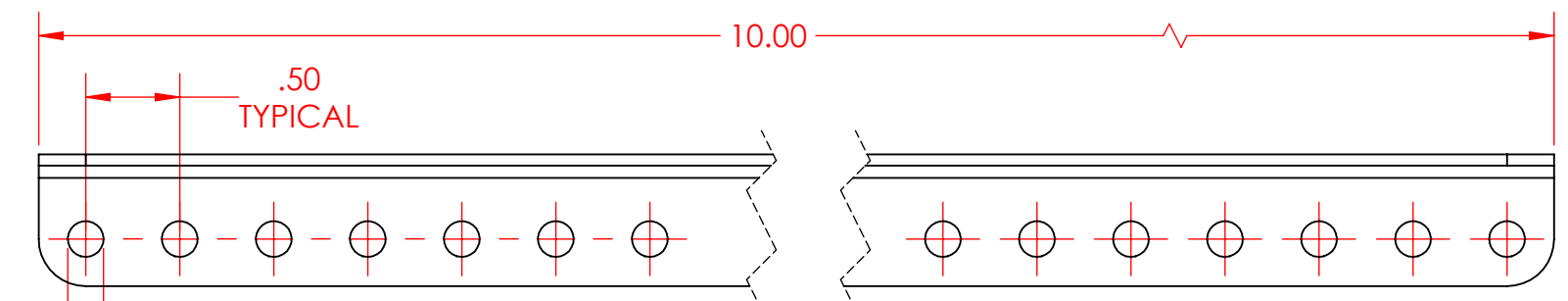

TOP VIEW BROKEN VIEW

$\phi .19$
ALL HOLES
CONCENTRIC
TO ROUND

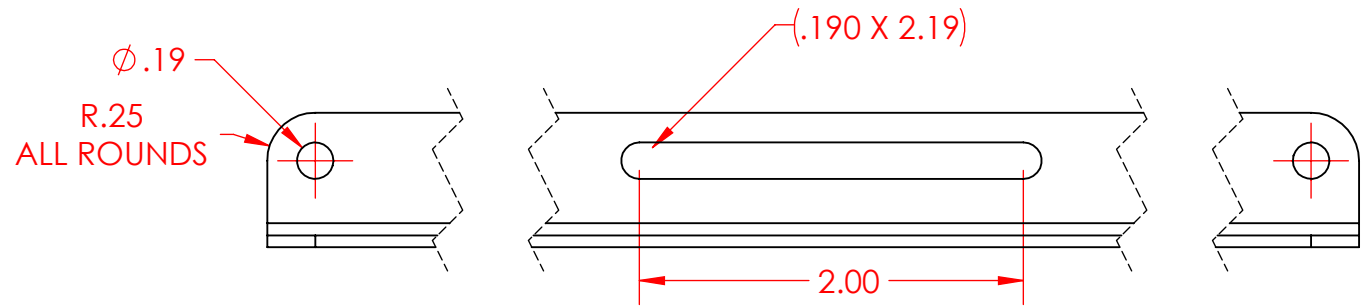

FRONT VIEW BROKEN VIEW

$\phi .19$
R.25
ALL ROUNDS

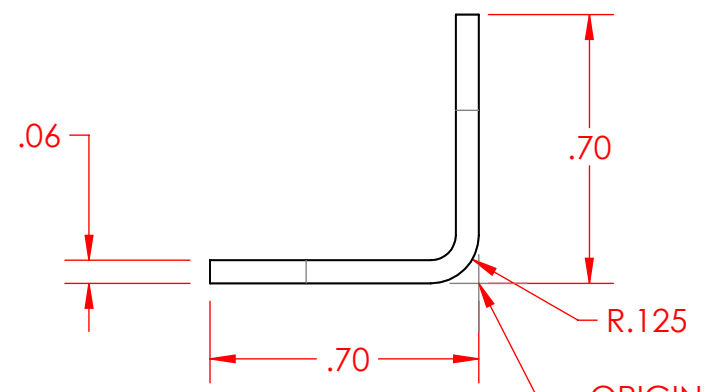

RIGHT VIEW SCALE 2:1

PROPRIETARY AND CONFIDENTIAL

THE INFORMATION CONTAINED IN THIS DRAWING AND ANY RELATED MATERIAL IS THE SOLE PROPERTY OF ENTERPRISE DESIGN AND INNOVATIONS. ANY SHARING OF THIS INFORMATION, IN WHOLE OR ANY PART THEREOF IS PROHIBITED WITHOUT EXPRESS WRITTEN CONSENT OF ENTERPRISE DESIGN AND INNOVATIONS.

"L" ANGLE 6874 ANGLED STEEL CUSHING PARTS				REVISIONS DATE:	ITEM:	NAME	DATE	UNITS IN INCHES TOLERANCES ARE 0.010 INCHES UNLESS OTHERWISE NOTED
						DRAWN	CSS	
		CHECKED	000	000				
		APPV.	000	000				
		MATERIAL	Alloy Steel					
SHEET 1	SHEET SCALE 1:1	SHEET SIZE B	REV	VERSION DATE	4/4/2018	SHEET FILE NAME: 02-Angle-Bracket		

